

Bearings are magnetic
Distances in metres
Elevation in ft AMSL
Coordinates WGS84

TWR
118.975

OLBIA / COSTA SMERALDA

LIEO 40°53'55" N 009°31'04" E

APRON 1		APRON 2		APRON 3	
Lighting	Bearing strength	Lighting	Bearing strength	Lighting	Bearing strength
Edge: BLUE	Surface: CONCRETE Strength: PCN 74/R/C/W/T	Edge: BLUE	Surface: CONCRETE Strength: PCN 81/R/C/W/T	Edge: BLUE	Surface: CONCRETE/ASPHALT Strength: STAND 29-37 PCN 31/F/C/W/T Strength: STAND 39-51 PCN 49/R/C/W/T

△ = PUSH-BACK ↻ = SELF-MANOEUVRING

APRON 1
POINTS ON PARKING AREA

STANDS		COORD.	
ID	ICAO CODE MAX ACFT ALLOWED	N	E
△ 101	C	40°54'06.62"	009°30'54.61"
△ 102	C	40°54'07.44"	009°30'56.29"
△ 103	C	40°54'08.31"	009°30'57.78"
△ 104	C	40°54'09.10"	009°30'59.35"
△ 105	C	40°54'09.97"	009°31'00.90"
↻ 106	C	40°54'06.03"	009°31'04.30"
↻ 107	C	40°54'04.88"	009°31'01.92"
↻ 108	C	40°54'03.60"	009°30'59.64"
↻ 109	C	40°54'02.48"	009°30'57.33"
↻ 110	D	40°53'59.90"	009°30'52.43"
↻ 111	D	40°53'58.30"	009°30'49.43"
↻ 112	C	40°54'01.97"	009°30'45.63"
↻ 113	C	40°54'03.17"	009°30'47.92"
↻ 114	C	40°54'04.32"	009°30'50.38"
↻ 115	C	40°54'05.31"	009°30'52.17"
↻ 116	C	40°54'18.50"	009°31'06.50"
↻ 117	C	40°54'20.80"	009°31'10.30"
↻ 118	GULFSTREAM V	40°54'22.30"	009°31'13.30"
↻ 119	GULFSTREAM V	40°54'24.20"	009°31'15.80"
↻ 21	A	40°54'08.88"	009°31'07.73"
↻ 22	A	40°54'08.34"	009°31'08.26"
↻ 23	A	40°54'09.53"	009°31'09.02"
↻ 24	A	40°54'09.08"	009°31'09.50"
↻ 25	A	40°54'10.29"	009°31'10.03"
↻ 26	A	40°54'09.62"	009°31'10.83"
↻ 27	A	40°54'10.93"	009°31'11.68"
↻ 28	A	40°54'10.43"	009°31'03.50"

APRON 3

STANDS		N	E
↻ 29	A	40°54'14.43"	009°31'21.30"
↻ 30	A	40°54'14.43"	009°31'21.38"
↻ 31	A	40°54'14.00"	009°31'20.75"
↻ 32	A	40°54'13.76"	009°31'20.10"
↻ 33	A	40°54'13.00"	009°31'18.88"
↻ 34	A	40°54'13.44"	009°31'19.40"
↻ 35	A	40°54'13.76"	009°31'20.13"
↻ 36	A	40°54'14.00"	009°31'20.77"
↻ 37	A	40°54'14.43"	009°31'21.39"
↻ 39	A	40°54'17.83"	009°31'26.38"
↻ 40	A	40°54'18.53"	009°31'27.02"
↻ 41	A	40°54'18.57"	009°31'27.84"
↻ 42	A	40°54'18.97"	009°31'28.58"
↻ 43	A	40°54'19.33"	009°31'29.91"
↻ 44	A	40°54'19.71"	009°31'30.05"
↻ 45	A	40°54'20.11"	009°31'30.78"
↻ 46	A	40°54'19.20"	009°31'31.54"
↻ 47	A	40°54'18.83"	009°31'30.70"
↻ 48	A	40°54'18.55"	009°31'30.00"
↻ 49	A	40°54'18.12"	009°31'29.36"
↻ 50	A	40°54'17.78"	009°31'28.56"
↻ 51	A	40°54'17.37"	009°31'27.83"

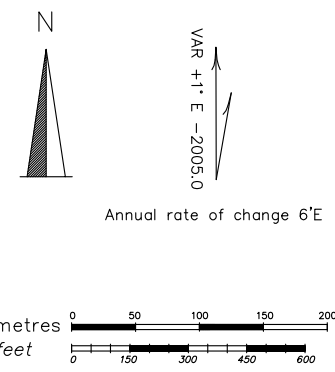
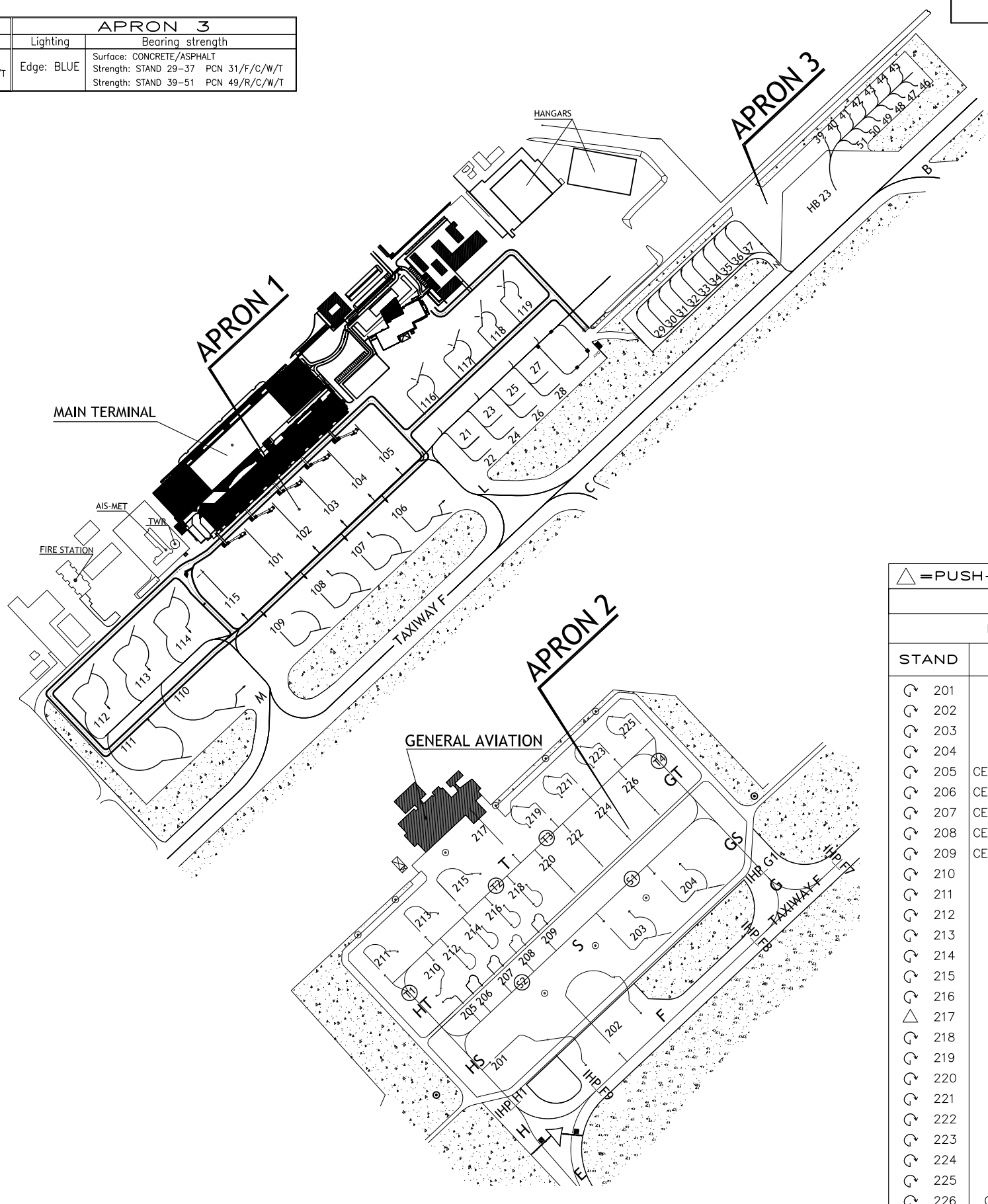

△ = PUSH-BACK ↻ = SELF-MANOEUVRING

APRON 2
POINTS ON PARKING AREA

STAND	MAX ACFT ALLOWED	N	E
↻ 201	B 767-300	40°53'40.54"	009°30'15.52"
↻ 202	B 767-300	40°53'42.38"	009°30'18.96"
↻ 203	B 737 - BBJ2	40°53'41.30"	009°30'21.90"
↻ 204	B 737 - BBJ2	40°53'42.70"	009°30'24.52"
↻ 205	CESSNA CITATIONJET	40°53'41.18"	009°30'12.58"
↻ 206	CESSNA CITATIONJET	40°53'40.68"	009°30'13.51"
↻ 207	CESSNA CITATIONJET	40°53'41.26"	009°30'14.59"
↻ 208	CESSNA CITATIONJET	40°53'41.87"	009°30'15.74"
↻ 209	CESSNA CITATIONJET	40°53'42.48"	009°30'16.89"
↻ 210	FALCON 900 B	40°53'40.58"	009°30'12.18"
↻ 211	GULFSTREAM V	40°53'42.11"	009°30'10.10"
↻ 212	FALCON 900 B	40°53'41.19"	009°30'13.50"
↻ 213	GULFSTREAM V	40°53'43.23"	009°30'12.20"
↻ 214	FALCON 900 B	40°53'41.81"	009°30'14.65"
↻ 215	B 737 - BBJ2	40°53'46.65"	009°30'13.14"
↻ 216	FALCON 900 B	40°53'42.42"	009°30'15.79"
△ 217	B 737 - BBJ2	40°53'46.46"	009°30'14.82"
↻ 218	FALCON 900 B	40°53'43.03"	009°30'16.94"
↻ 219	GULFSTREAM V	40°53'46.49"	009°30'16.82"
↻ 220	B 737 - BBJ	40°53'44.15"	009°30'20.21"
↻ 221	GULFSTREAM V	40°53'47.37"	009°30'18.46"
↻ 222	B 737 - BBJ	40°53'44.15"	009°30'20.21"
↻ 223	GULFSTREAM V	40°53'48.25"	009°30'20.11"
↻ 224	B 737 - BBJ	40°53'44.92"	009°30'21.65"
↻ 225	GULFSTREAM V	40°53'49.12"	009°30'21.75"
↻ 226	GLOBAL EXPRESS	40°53'47.92"	009°30'21.83"